

HealthID

ADVANCED CONVENIENCE. ENHANCED CARE.



REGISTERING A PATIENT ON CARDIO CARE PROGRAMME

DISCOVERY HEALTH
2023





How to register a patient on cardio care programme

- Ensure the patient has an approved Hypertension Chronic Illness Benefit (CIB) application

The screenshot shows the HealthID interface for a patient's Chronic Illness Benefit application. The patient's details are: igmmfmbhlc Vabmmfmbhlc | 5812265145089 | 63, Male | +27 11 111 1111 | test@discovery.co.za. The application is currently Active. A table lists the application details:

DESCRIPTION	DATE DIAGNOSED	STATUS	ACTIONS
Hypertension	28/11/2022	Approved	Manage Add and remove medicine/item

Below the table is a History section with a message: "There is currently no history of chronic authorisations for this patient."

- Navigate to the Care Programmes menu item

The screenshot shows the HealthID navigation menu. The menu items are: Patient's file, Overview, Clinical (with a sub-menu), Consultation, Medical history, Sick notes, Prescriptions, KeyCare Referral, Scheme Admin (with a sub-menu), Scheme info, Hospital auth, Benefit application, Chronic application, and Care programme. The 'Care programme' item is highlighted in blue.



- Click “New Application” to start the registration process. Cardio Care will be preselected if the patient is eligible for the programme.

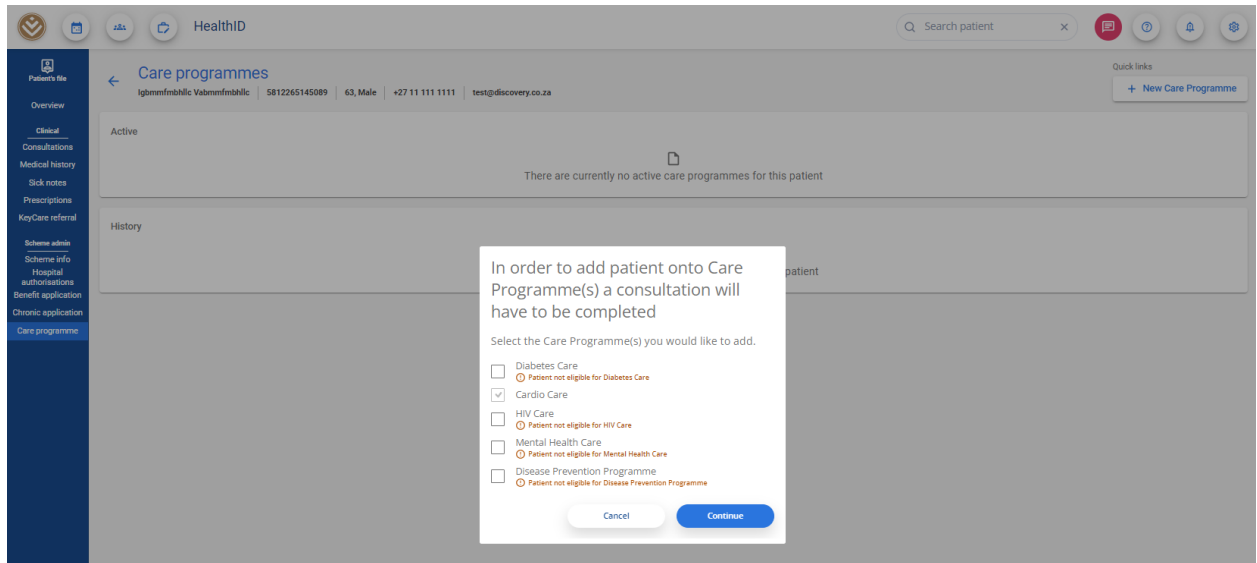

- Click “Continue” to to request an OTP from the patient to start the enrolment consultation

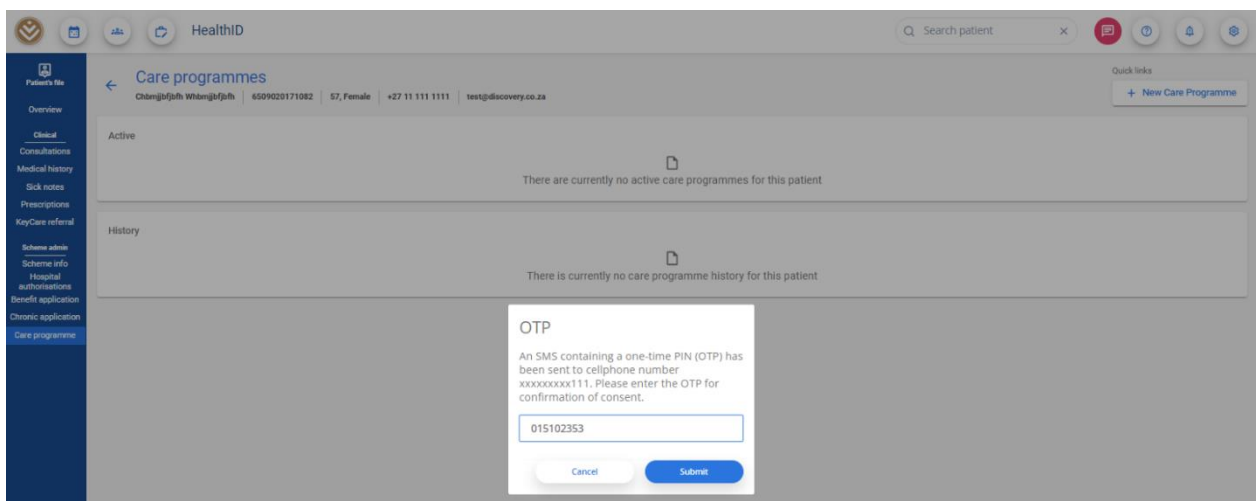

- The diagnosis for the consultation will be prepopulated as the same diagnosis used for the Hypertension CIB

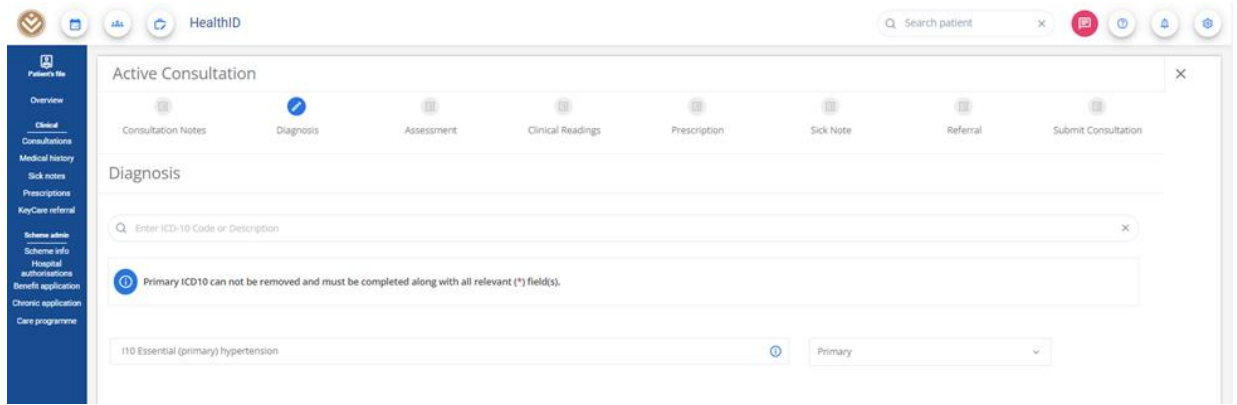

- A mandatory PHQ2 assessment needs to be completed for the Cardio Care registration consultation.

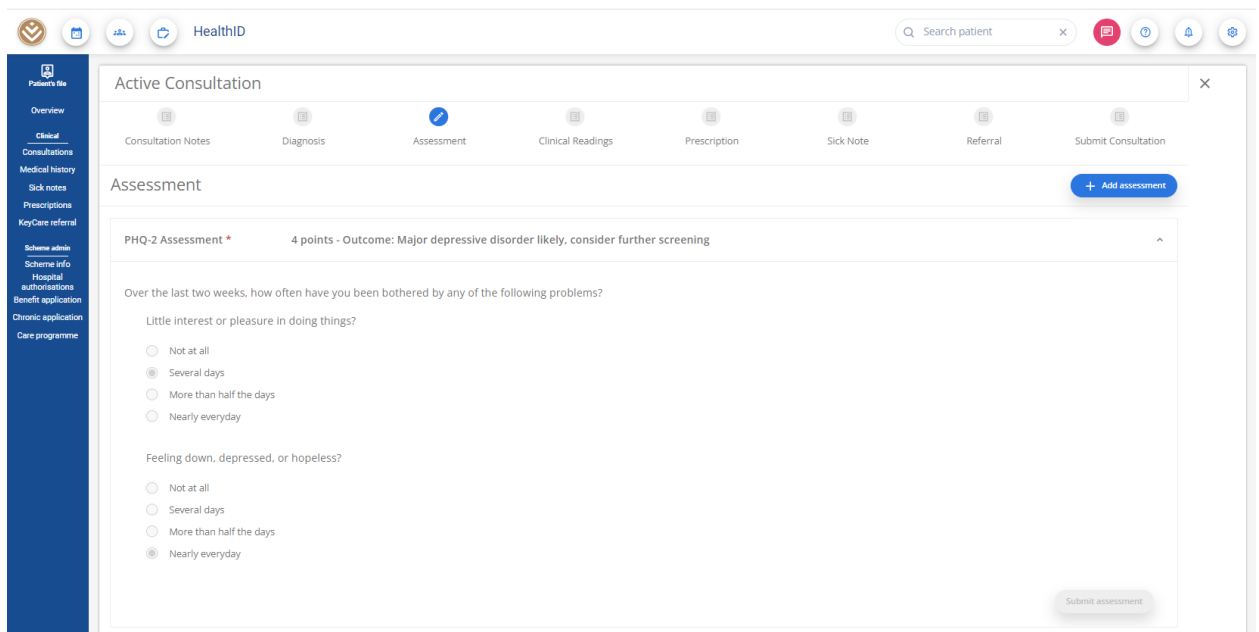

- Weight, height, waist circumference, and smoking status need to be captured under the Clinical Readings section to proceed with the registration.



READING TYPE	LAST READING SOURCE	LAST READING	CAPTURE READING
BMI *	N/A	N/A	24.7 kg/m2
Weight *	N/A	N/A	89 kg
Height *	N/A	N/A	1.9 m
Smoking status *	N/A	N/A	No
Waist Circumference	N/A	N/A	Capture cm
Hip Circumference	N/A	N/A	Capture cm
Waist to Hip ratio	N/A	N/A	Autocalculated m

- The rest of the consultation is optional for the enrollment. Note, the medication captured in this consultation will not be added to the CIB medication list.

- Once the consultation is submitted, the patient will be registered on the Cardio Care programme.

PROGRAMMES	START DATE	STATUS	ACTIONS
Cardio Care	12/12/2022	Approved	Manage End programme